

Peter
illingworth
ESTATE AGENTS



**2, Keld Head Road, Kirkbymoorside,
York, YO62 6EN
Price Guide £232,000**

www.peterillingworth.co.uk

A much cherished three bedroom centrally heated, sealed unit double glazed, semi-detached dwelling house, including: solar panels (connected to the Grid) conservatory, cloak room, garage, car standing area and landscaped gardens, situated to the north of Kirkbymoorside on this popular estate, situated off the Gillamoor Road.

Accommodation briefly comprises: front entrance lobby, cloakroom, sitting room, archway to dining room plus fitted kitchen and conservatory. First Floor: Two double bedrooms, single bedroom and house shower room.

Kirkbymoorside is often referred to as the Gateway to the North York Moors National Park. This ancient market town has a wide range of facilities and falls within the catchment area of the highly regarded Ryedale School as well as Kirkbymoorside Community Primary School. The town has a very popular 18 hole golf course and recreational facilities. The renowned North York Moors National Park and the Great Dalby Forest are located close by. The ancient city of York and the coastal resorts of Scarborough and Whitby are easily commutable.



Ground Floor

Approx. 45.6 sq. metres (490.8 sq. feet)

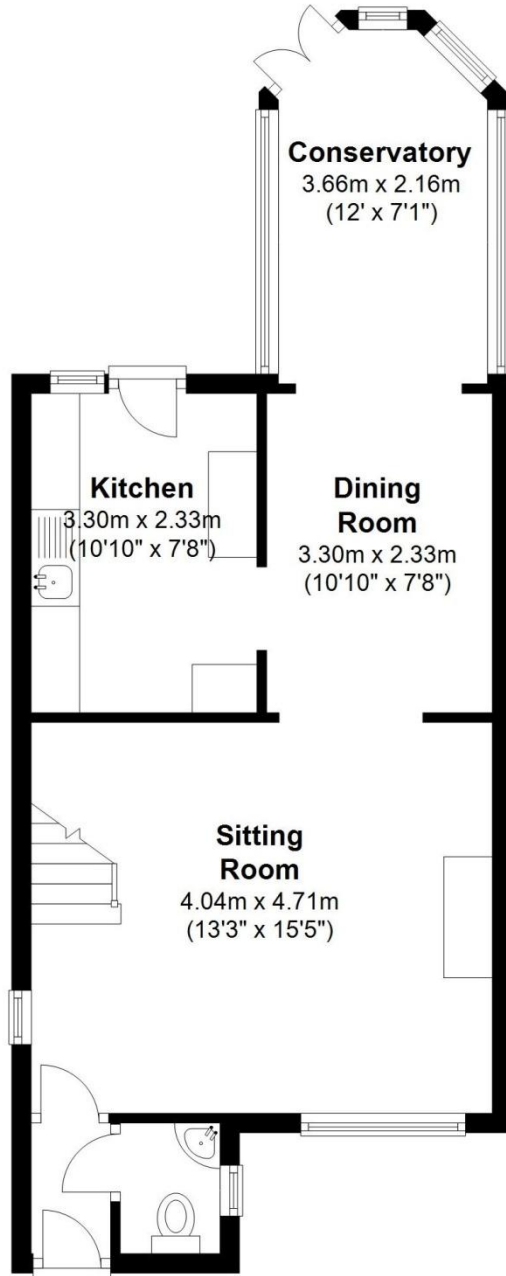

First Floor

Approx. 35.3 sq. metres (380.2 sq. feet)

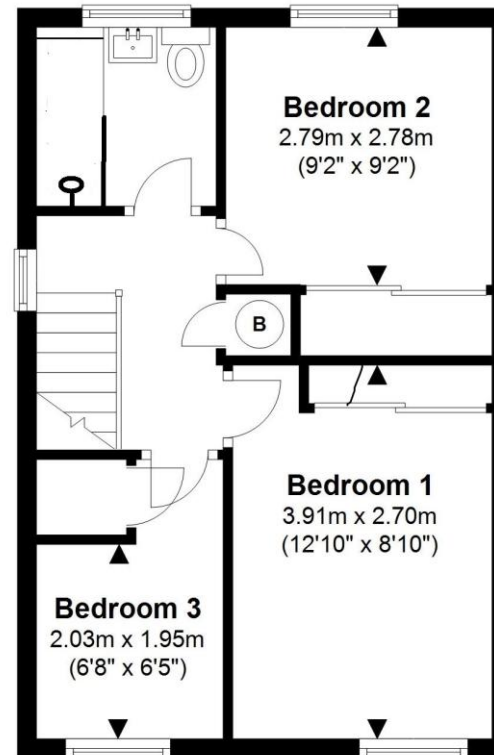

Total area: approx. 80.9 sq. metres (871.0 sq. feet)

2 Keld Head Road, Kirkbymoorside

For information purposes, not to scale





Tenure: We understand the property to be freehold. Freehold vacant possession will be given on completion.

Services: Mains gas, drainage and electricity are laid on. Gas fired central heating. Solar Panels connected into the Grid.

Property Tax: Band C

Energy Performance Rating: Band C

Location:

What3words///throw.deeply.nightcap

Photography: By Peter Illingworth

Need to sell your own property?

Contact Peter Illingworth on 01751 431107 for no-obligation advice.

Need advice on buying through another agent?

Contact Peter Illingworth on 01751 431107 to discuss how we can give you the comfort of many years of our expertise, in representing clients in the purchase of their next home.

Viewing:

Strictly by appointment through the Agents Kirkbymoorside Office, 16 Market Place, Kirkbymoorside, York. Tel: 01751 431107.



www.peterillingworth.co.uk

16 Market Place, Kirkbymoorside, York, YO62 6DA
T. 01751 431107
E. kirkbymoorside@peterillingworth.co.uk

Champley's Mews, Market Place, Pickering, North Yorkshire, YO18 7AE
T. 01751 475557
E. pickering@peterillingworth.co.uk

Cashel House, 15 Thyer Street, London W1U 3JT
T. 0870 1127099
E. info@mayfair.co.uk W. www.mayfairoffice.co.uk

 MAYFAIR
office.co.uk

 NAEA
National Association of
Estate Agents

 TheMarket.com

 The Property
Ombudsman
2015

Important Notice:

- Peter Illingworth Estate Agents for themselves and for the Vendors or Lessors of this property, whose agents they are; give notice that:
- the particulars are set out as a general outline only for the guidance of intending purchasers or lessees and do not constitute, nor constitute part of, an offer or contract;
 - all descriptions, dimensions, references to condition and necessary permissions for use and occupation and other details are given without responsibility and any intending purchasers or tenants should not rely on them as statements or representatives of fact but must satisfy

- themselves, by inspection or otherwise, as to the correctness of each of them;
- no person in the employment of Peter Illingworth Estate Agents has any authority to make or give any representation or warranty given whether by Peter Illingworth Estate Agents and Associates or the Vendors or the Lessors of this property.
- It is the responsibility of any intending purchaser to satisfy himself as to the accuracy of any information upon which he relies in making an offer. The making of any offer for this property will be taken as an admission by the intending purchaser that he has relied solely upon his own personally verified information, inspection and enquiries.